

Serena

by  **LUTRON**

See how easy it is to:

- Measure for Serena shades
- Choose and program controls
- Install shades
- Change batteries
- Integrate with other systems

For more information and step-by-step videos, please visit lutron.com/serena.



Lutron Electronics Co., Inc.
7200 Suter Road
Coopersburg, PA 18036-1299

Customer Service 1.855.573.7362
Contact a Serena Shade Specialist 7 days a week
8 a.m. – 8 p.m. Mon – Fri Eastern
9 a.m. – 6 p.m. Sat – Sun Eastern
World Headquarters 1.610.282.3800
Technical Support 1.800.523.9466 — Available 24/7

Apple is a trademark of Apple Inc., registered in the U.S. and other countries. Homekit is a trademark of Apple Inc.

Google is a registered trademark of Google Inc.

 **LUTRON**, Lutron, Caséta, Claro, Pico, and Serena are trademarks of Lutron Electronics Co., Inc., registered in the U.S. and other countries.

© 01/2018 Lutron Electronics Co., Inc. | P/N 367-2447 REV E



Smart shades
at an affordable price



Synchronized.
Silent. Smart.



Maximum comfort and convenience

What if you could schedule your window shades to automatically raise at a set time every morning, so you could wake up to a soft light? Or close your shades before you get into your tub, and then open them with the press of a button to enjoy the view?

What if you could integrate your shades with other smart home solutions, to create a one-of-a-kind experience?

With Serena automated shades, you can enjoy those conveniences, and more!

Our ultra-quiet battery-powered shades install wirelessly. Designed with your lifestyle in mind, you can control them from anywhere in the room via remote or anywhere in the world with the free Lutron App.



Why Serena?



Easy to Install

Shades install and operate without wires. You can mount them inside or outside the window frame.

Low Maintenance

Shades feature industry-leading battery performance, and you can replace the batteries without taking down the shade.

Cordless Design

A safer solution for homes with children or pets.

Two Design Choices

Available in roller or insulating honeycomb styles, with a variety of headrail options.

Fashionable Aesthetics

Choose from a wide selection of fabric colors and textures, as well as three opacities.

Smart Device Control

Use the Smart Bridge and free Lutron App for convenient control from anywhere.

You can also integrate shade control with other smart home solutions, including Amazon Alexa, Apple® HomeKit™, Google® Assistant, and more!

Warranty

Shades are backed by Lutron's 8-year warranty.

24/7 Support

Dedicated Shades Specialist and Technical Support teams based in the U.S.

Roller Shades



Contemporary and stylish, roller shades are available in a wide variety of colors, from neutrals to vibrant bolds. Unique textures such as two-toned weaves, woven fibers, and delicate linens add to your design choices.

- Available as wide as 96" and as tall as 120"
- Uses 6–8 store-bought D-cell alkaline batteries, depending on shade size
- Sheer, translucent, and blackout fabric options
- Available with or without fascia
- Innovative headrail simply rotates forward to replace batteries without removing the shade



Insulating Honeycomb Shades



Insulating honeycomb shades add a signature look to any space. Choose from woven linens and airy sheers, in traditional neutrals as well as bold hues.

- Available as wide as 96" and as tall as 104"
- Uses 4–8 store-bought AA lithium or D-cell alkaline batteries, depending on shade size
- Sheer, light-filtering, and room-darkening fabric options
- Our exclusive Tap n' Tilt technology makes changing batteries a breeze, without ever taking down the shade



Convenient Control



Place a Pico remote control on your nightstand so you can open your shades to let the sun shine in without getting out of bed.

- Remote is easy to program
- Pedestal (sold separately) adds a finished look
- Available in many colors for any aesthetic
- Remote uses Lutron reliable Clear Connect RF technology, which operates on a quiet frequency band that's free of interference



Pico on pedestal
(sold separately)

Control Where You Want It



Add an additional point of control by mounting a Pico on your wall.

- Mount to any surface
- No cutting holes or wiring required
- Fits in a standard wallplate, including Lutron's screwless Claro wallplate
- Has a 10-year battery life

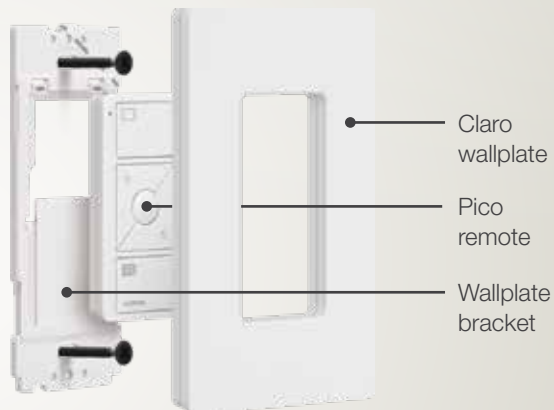

Pico remote wall-mounting kit
(sold separately)

Multi-group Control



Create the perfect view or eliminate glare by controlling different groups of shades with a wireless 4-group remote.

- Control groups of shades with the touch of a button
- Control one group at a time or all groups at once
- Set and recall preferred shade levels with the Favorite button

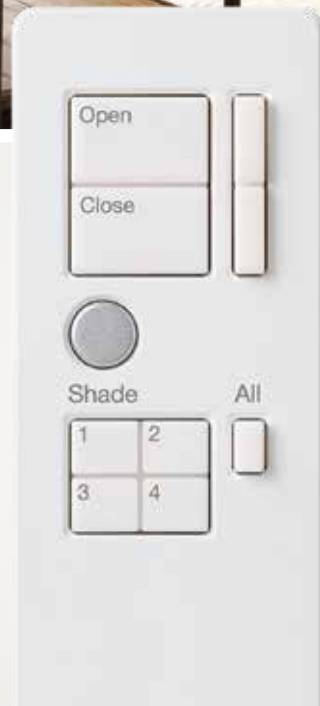

Lutron App & Smart Bridge



You can easily make Serena shades part of your connected home. All you need is the Lutron Smart Bridge and free Lutron App. With the app, you can monitor and control shades from anywhere with your smart device.

- Simple setup
- Create personalized scenes and schedules
- Add Caséta by Lutron smart lighting control; monitor and control lights as well as shades with your smart device; schedule shades and lights to adjust together, or create personalized lights and shades scenes

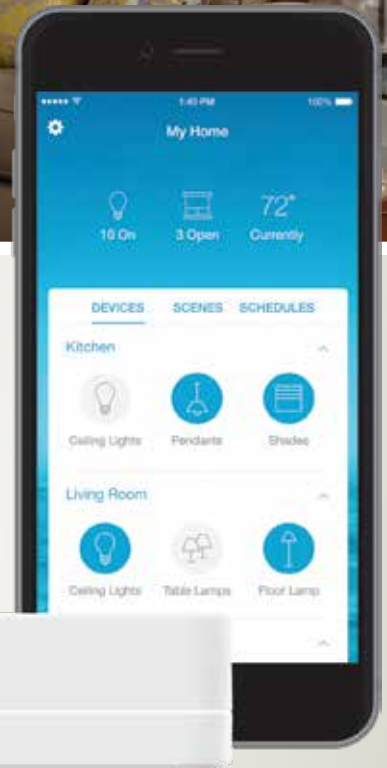

Add Additional Smart Home Products



Amazon Alexa

Lutron Caséta dimmer

Nest

The Lutron Smart Bridge also works with other leading smart home brands, for seamless integration with thermostats, other manufacturers' apps, and more. Expand your system and add even more convenience to your day to day. Here are just a few examples of what integration can do for you:

- Busy making dinner? Control lights and shades with your voice.
- Smoke or CO₂ detected? Lights turn on and shades open.
- Heading home from vacation? Adjust the temperature before you get to your front door.

